



EAGLE CANYON ESTATES



SILVERADOHOMES.COM

FEATURES

At First Glance

- Low maintenance stucco exterior
- Concrete tile roofs
- Garage door opener
- Side garage door
- Air conditioning
- Waterproof outdoor electric outlet (front and rear)
- Two hose bibs
- Illuminated address numbers

Interiors

- Two-tone paint
- Ceramic tile flooring in kitchen, baths, entry, and laundry room
- Brushed nickel door hardware
- Radius wall corners
- Wood windowsills and aprons
- 2 panel 8'-0" interior doors
- Ceiling fans pre-wired in both master bedroom and great room
- Pre-wired for phone and cable outlets in pre-determined locations
- Quality birch cabinetry
- Overhead lighting in secondary bedrooms
- Recessed lighting

Primary Bedroom and Bathroom

- Walk-in closet with built in shelving
- Solid surface vanities with dual sinks
- Separate oval tub and shower
- Quality birch cabinets

Kitchen

- Oversized kitchen islands
- Granite slab counter tops
- Built-in stainless steel GE appliances
- Quality birch cabinets
- Double compartment under mount stainless steel sink with disposal
- Recessed lighting
- Pendant lighting
- Kitchen pantry

Energy Conservation Features

- 2018 International Energy Conservation Code standards for insulation
- Dual-paned low energy vinyl windows
- High-efficiency gas forced air heating with pilotless ignition
- Energy saving insulated fifty gallon gas water heater
- 8' Weather resistant fiberglass entry door

Customizing Opportunities

- Floor plan configurations: Den, bedroom, or baths (per plan)
- Upgraded bath and kitchen counter selections
- Upgraded cabinetry selections
- Upgraded kitchen appliances
- Texture and paint garage
- Garage insulation
- Jetted tub
- Many electrical and plumbing options
- Covered Patio
- Gas fireplace with log set
- Garage glass window - Elevation B
- Oversized Sliding Glass Door

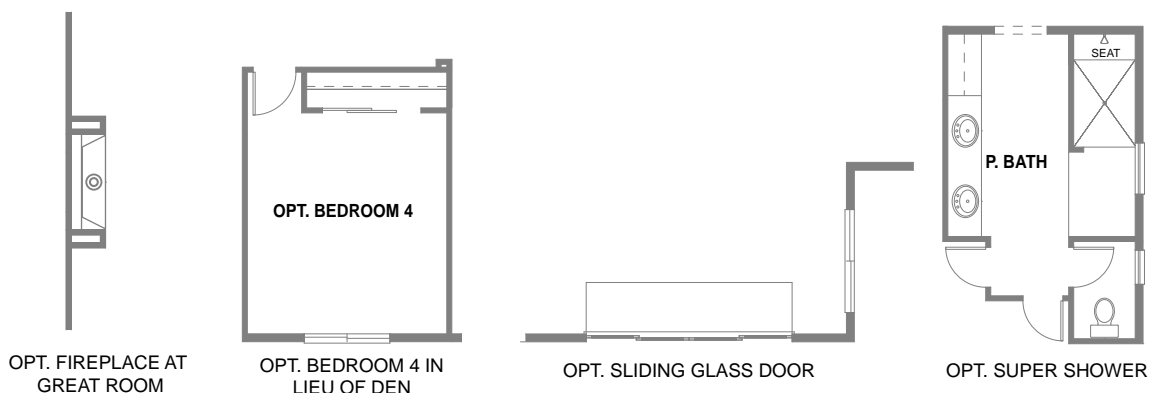

PLAN 1 FLOOR PLAN

2,788 SQUARE FEET | 3 BEDROOMS + DEN | 2.5 BATHROOMS | 3-CAR GARAGE



ELEVATION A



ELEVATION B



ELEVATION C

- 3 BEDROOMS + DEN
- 2.5 BATHROOMS
- 3-CAR GARAGE
- 2,788 SQUARE FEET
- 1 STORY

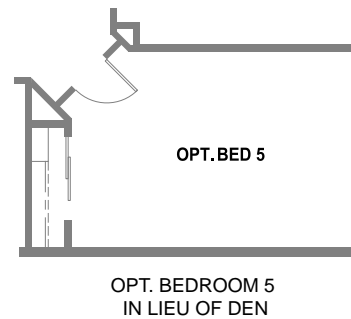
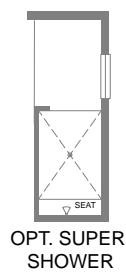
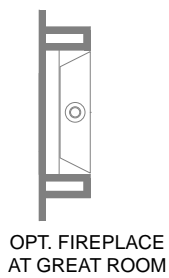

PLAN 2 FLOOR PLAN

3,108 SQUARE FEET | 4 BEDROOMS + DEN | 3 BATHROOMS | 3-CAR GARAGE



ELEVATION A



ELEVATION B



ELEVATION C

- 4 BEDROOMS + DEN
- 3 BATHROOMS
- 3-CAR GARAGE
- 3,108 SQUARE FEET
- 1 STORY

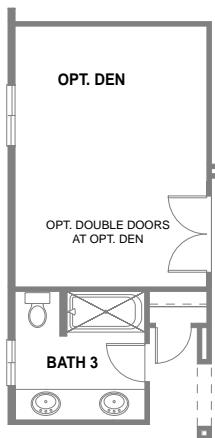
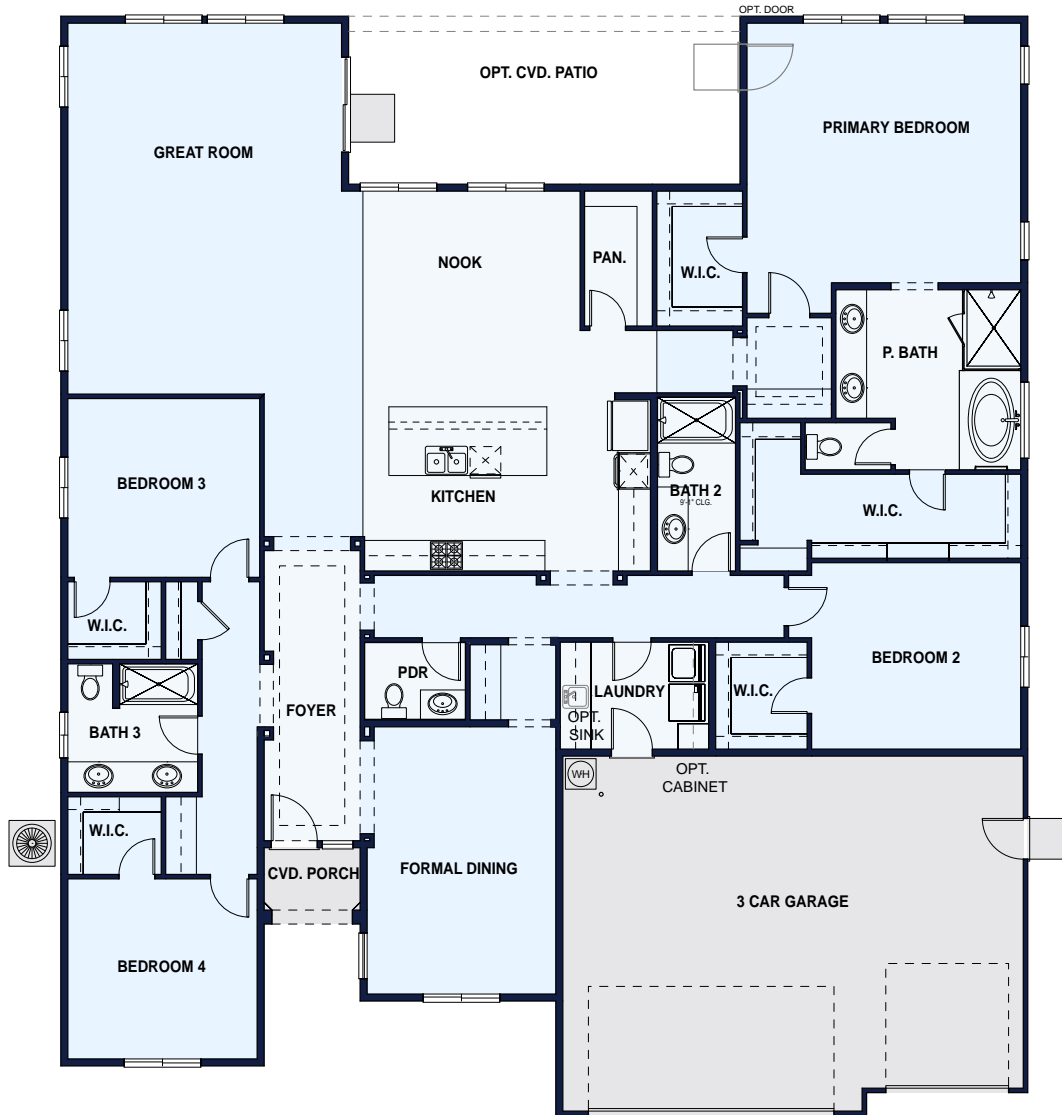

OPT. DEN IN LIEU OF BEDROOM 3

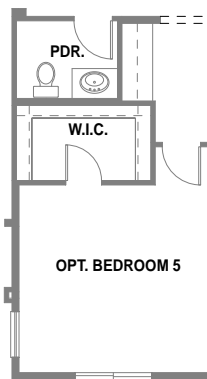

OPT. BEDROOM 5 IN LIEU OF FORMAL DINING



OPT. FIREPLACE AT GREAT ROOM

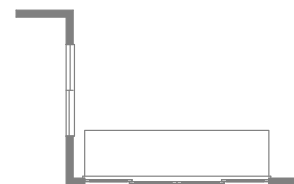

OPT. SLIDING GLASS DOOR

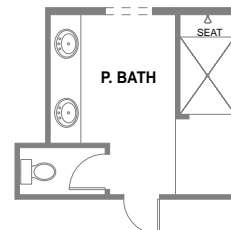

OPT. SUPER SHOWER

PLAN 3 FLOOR PLAN

3,291 SQUARE FEET | 4 BEDROOMS + FORMAL DINING | 3.5 BATHROOMS | 3 CAR GARAGE



ELEVATION A



ELEVATION B



ELEVATION C

- 4 BEDROOMS + FORMAL DINING
- 3.5 BATHROOMS
- 3-CAR GARAGE
- 3,291 SQUARE FEET
- 1 STORY

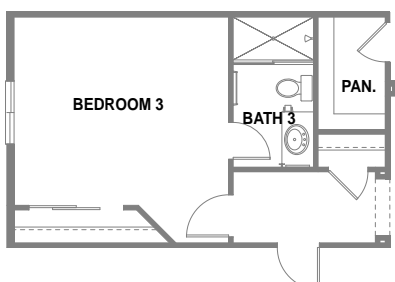

OPT. BEDROOM 3
w/ BATH 3 IN LIEU OF DEN

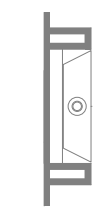

OPT. FIREPLACE



OPT. SLIDING GLASS DOOR

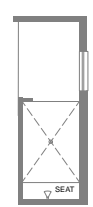

OPT. SUPER
SHOWER

PLAN 4 FLOOR PLAN

3,246 SQUARE FEET | 3 BEDROOMS + MULTI-GEN LIVING | 3 BATHROOMS | 3 CAR GARAGE

© 2019 Silverado Companies. All rights reserved. Prices, plans, and terms are effective on the date of publication and subject to change without notice. Square footage/acreage shown is only an estimate and actual square footage/acreage will differ. This website contains general information about a new home community(ies) and it is not an offer or the solicitation of an offer for the purchase of a new home. Depictions of homes and features are artist conceptions. Interior design elements, hardscape, landscape, and other items shown may be decorator suggestions that are not included in the purchase price and availability may vary. Artwork, virtual reality images and views may also be altered by subsequent development, construction, and landscaping growth. Plans to build out this neighborhood as proposed are subject to change without notice. Silverado Homes does not represent and cannot guarantee to potential buyers that the project will be serviced by any particular agencies, school districts or other services for any particular period of time. NCL# 0070796 Lic# 0004316



ELEVATION A



ELEVATION B



ELEVATION C

- 3 BEDROOMS + KITCHENETTE/ LIVING
- 3 BATHROOMS
- 3-CAR GARAGE
- 3,246 SQUARE FEET
- 1 STORY



SITE MAP



EAGLE CANYON ESTATES

SILVERADOHOMES.COM

★
**DIRECTIONS TO
COMMUNITY**

EAGLE CANYON ESTATES
905 Sand Springs Drive
Sparks, Nevada 89441

★
**DIRECTIONS TO
TEMPORARY SALES OFFICE**

1206 Mallard Crest Drive
Sparks, NV 89441

Take Interstate 80 to Pyramid Highway
Head West on Eagle Canyon Drive
Take a right at the 2nd Roundabout
Onto Neighborhood Way
Follow about 0.8 miles and then
Left on Sand Springs Drive

(775) 376-1792

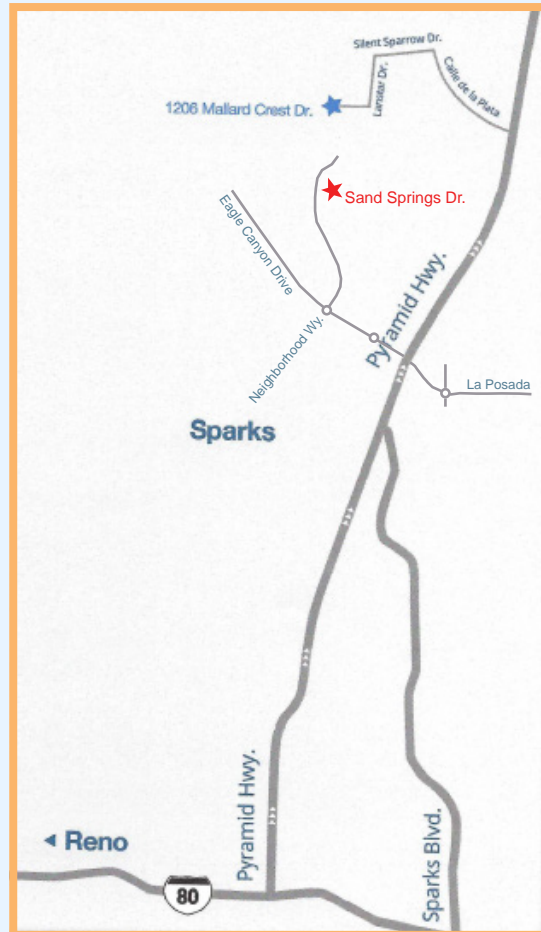

EAGLE CANYON ESTATES